

SEAL-TITE™ CORNER SEAL

Pressure sensitive elastomer with fleece-back lining

Seal-Tite™ Corner Seal is a heavy-duty material for sealing exterior RV walls and ceilings. Applied before the molding, Corner Seal provides a durable, flexible, virtually impermeable seal between the unfinished union of the walls and ceilings.

The high-tack adhesive side contains flexible elastomers that create a strong flexible bond, while the fleece side allows for easy molding repositioning during installation. When correctly installed, Corner Seal provides a permanent intermeshing bond.

HOW TO APPLY SEAL-TITE CORNER SEAL

1. Begin by removing the insert trim, screws and molding from the desired area. Remove the molding carefully so that it will be in the best condition possible when you reinstall at the end of the process. Avoid kinking or bending.
2. Carefully scrape away all conventional putty and sealants on the inside of the corner molding.
3. Clean the area on the RV where the Corner Seal Tape will be applied, first with soapy water and then with denatured alcohol on a clean cloth.
4. Replace any rusty or damaged staples in the corner area to hold the metal pieces together as tightly as possible.
5. To ensure the Corner Seal Tape is applied as accurately as possible, temporarily hold the corner molding on the RV corner being repaired and mark along edge of the molding with a pencil to form a guideline for the tape. Set corner molding aside.
6. Apply Corner Seal Tape from the top of the seam down to the bottom, keeping the tape as straight as possible, and pressing firmly to make sure the tape conforms to the siding.
7. Place a bead of Dicor Cap Sealant along the inside of corner molding.
8. Inspect and replace any rusty screws or damaged molding to ensure a tight seal. Replace the corner molding with the screws. Do not overtighten screws. Tighten until sealant just begins to ooze out from under the edges of the molding.

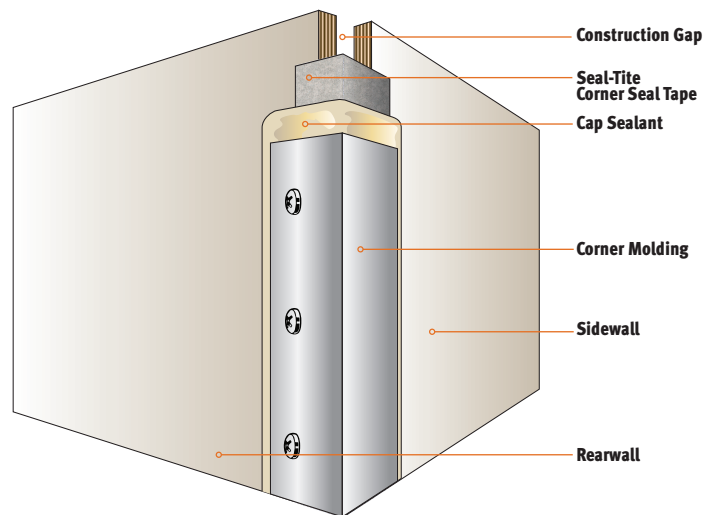

9. Clean sealant from edges of molding using a clean cloth and soapy water.
10. Apply new insert trim.

You have successfully applied Seal-Tite Corner Seal to your RV, creating a virtually impermeable seal that will last!

Disclaimer: If your Corner Seal roll is shipped during the warm summer months, it is possible your roll can become sticky. Simply place Corner Seal roll in the freezer for a few minutes to regain firmness.



Watch our instructional video at
www.sealdesignllc.com/videos-5